

# CMLX | Compression latches with padlock holes

with key-type knob, zinc alloy



- 1
- 2
- 3
- 4
- 5
- 6
- 7
- 8
- 9
- 10
- 11
- 12
- 13
- 14
- 15
- 16
- 17
- 18

## MATERIAL

Rotor, stator and knob in nickel-plated zinc alloy.

## NUT

M19x1 in brass.

## TOOTHED WASHER

Zinc-plated steel.

## PACKING RING

NBR rubber.

## CLOSING LEVER

Zinc-plated steel, thickness 2.5 mm.

## SCREW

M5x10 zinc-plated steel.

## FLAT AND ELASTIC WASHERS

Zinc-plated steel.

## INTERNAL SPRING

Stainless steel.

## ROTATION

90°.

## FEATURES AND APPLICATIONS

CMLX compression latches are particularly suitable for applications on cabinets or doors subject to strong vibrations.

Provided with a transversal hole for the insertion of a padlock with hook of a diameter from 5 to 7 mm.

The lever rotation is only possible through the knob compression.

## SPECIAL EXECUTIONS AND ACCESSORIES

- Closing levers in other dimensions.
- Brass threaded extension for prolonged positioning of the lever (code 421137 C.PQ M5/58).

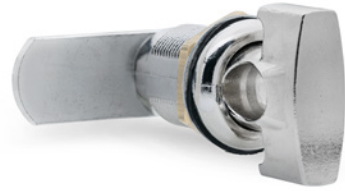

Drilling template

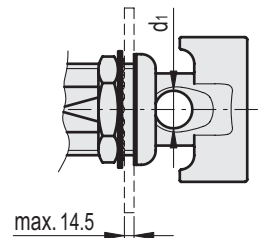
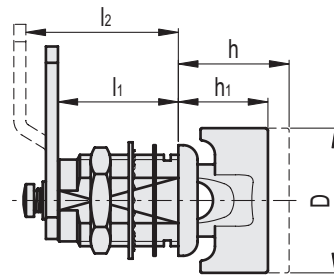
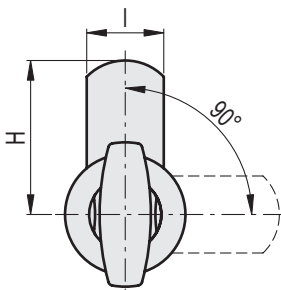
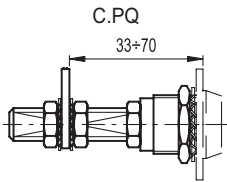
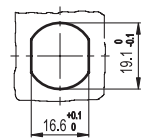

Conversion Table			
1 mm = 0.039 inch			
H		l2	
mm	inch	mm	inch
32	1.26	30	1.18
35.5	1.40		

Code	Description	H	D	l	l1	l2	d1	h	h1	⚖
421231	CMLX.32-25	32	30	16	25	-	8	23	18.5	79
421233	CMLX.36-30	35.5	30	16	25	30	8	23	18.5	81

**METRIC**